

Unless it has been agreed otherwise it is strictly forbidden to copy distribute, disclose or trade this document or it's content. Anybody in breach of this ban will be held liable for full compensation. All right's reserved, especially the right for patent or registered design lodgement.

除事先同意，严禁复制、散发、披露或以此文件及其内容进行买卖交易。任何违背此禁令者需承担全部赔偿责任。保留所有权利，特别是专利及版权已注册的设计所有权。

借(通)用件登记

旧底图总号

底图总号

签 字

日 期

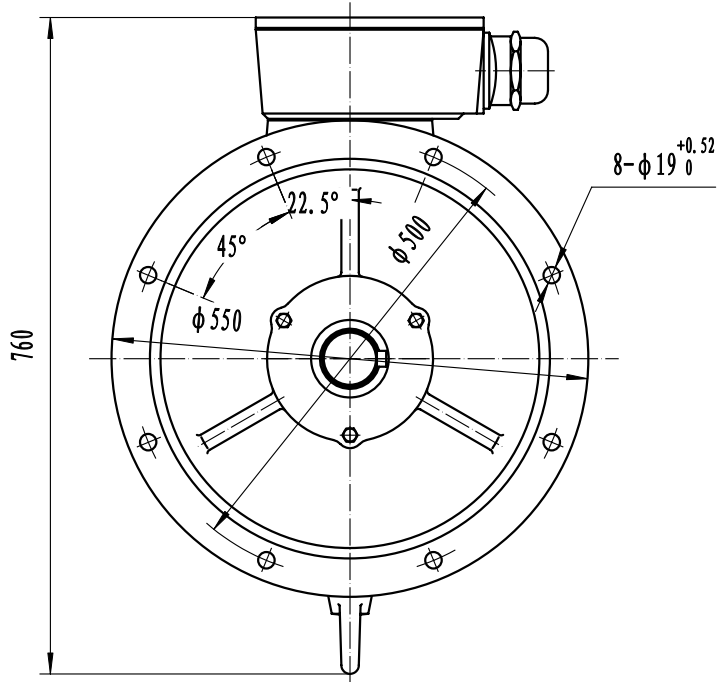
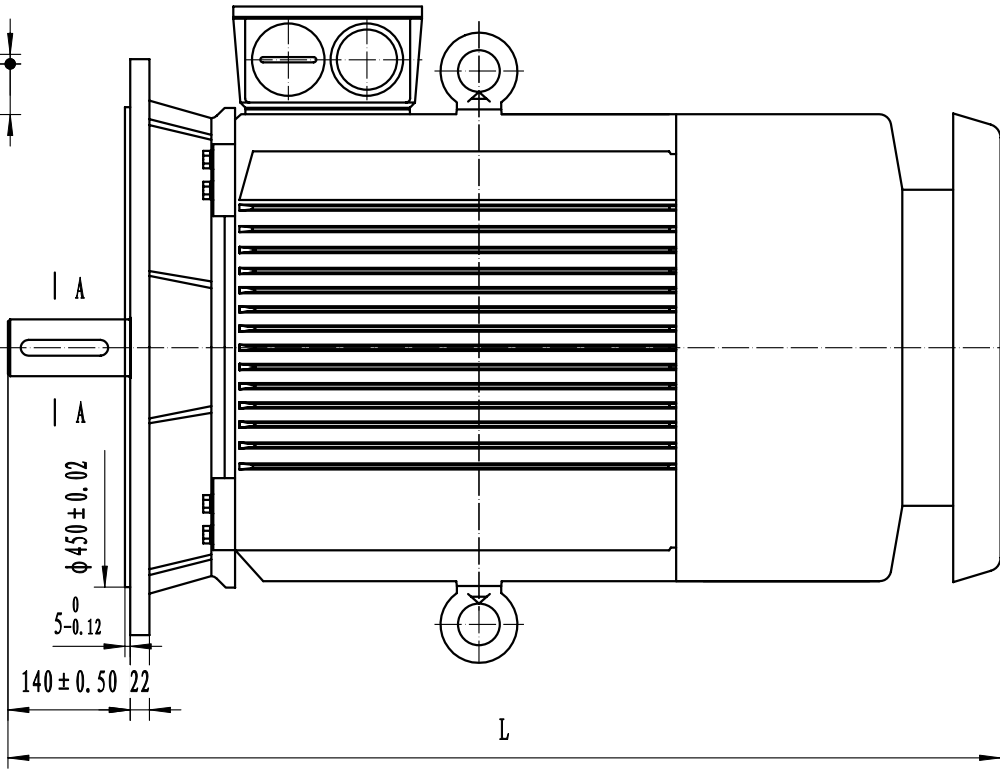
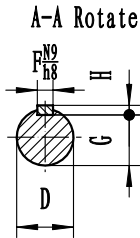

Type	Power (kW)	D	G	F	H	L
1LG0280-2AB	75	$\Phi 65 \begin{smallmatrix} +0.030 \\ +0.011 \end{smallmatrix}$	$58 -0.20$	18	$11 -0.110$	1040
1LG0283-2AB	90					1090
1LG0280-4AA	75	$\Phi 75 \begin{smallmatrix} +0.030 \\ +0.011 \end{smallmatrix}$	$67.5 -0.20$	20	$12 -0.110$	1060
1LG0283-4AA	90					1110
1LG0280-6AB	45					1060
1LG0283-6AB	55					1110

注：电机（指实物）安装尺寸符合图中尺寸，外形尺寸不大于图中尺寸。

Note: Dimensions of mounting shall accord with drawing's dimensions, outline dimensions shall not exceed the drawing's dimensions.

							Siemens Standard Motors Ltd.		
标记	处数	分区	更改文件号	签 名	日 期				1LG0-280(V1)
设计	孙梅	20080724	标准化			阶段标记	重量	比例	Dimension of mounting and outline
校对			审定				B	1:6	
审核	王庆中	20080725				共	张	第	张
工艺			批准						